

**Models 581 582  
Bolt Action Rifles  
22 Caliber  
Owner's Manual**

*Remington*<sup>®</sup>

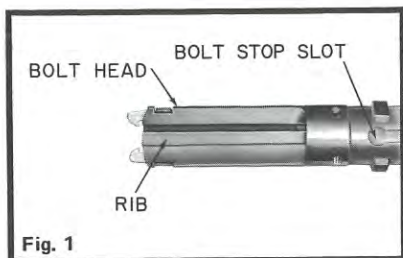

Fig. 1

The Remington Models 581 and 582 are chambered for short, long or long rifle cartridges. An extremely strong locking system is featured and a full length Monte Carlo stock is offered as a standard item. These rifles are shipped from the factory with bolt taken down.

**TO PUT BOLT IN RIFLE** — Align bolt stop slot on bolt body (Fig. 1) with rib on bottom (flat) of bolt head. Rotate and hold safety (Fig. 3) completely forward.

With firing pin on top of bolt head (in 12 o'clock position) insert and push bolt forward into receiver. When locking lugs on bolt are no longer visible, safety may be released. **TO COCK BOLT** — Bolt must be cocked to put into rifle. Should bolt become uncocked, cocking piece (Fig. 2) will snap forward into cocking cam in rear of bolt. Slide cocking piece rearward (it is recommended that vise jaws or other suitable clamping be used) and rotate bolt plug clockwise or lift bolt handle until cocking piece will snap into detent on rear edge of bolt.

**SAFETY** — (Fig. 3) Rotate safety to rear stop position marked "S" on receiver. Trigger cannot be pulled to fire rifle.

**TO SINGLE LOAD** — Put safety **ON SAFE**. Place cartridge directly into chamber and close bolt. Put safety **ON SAFE**. Point muzzle in a safe direction. Place cartridge directly into chamber, slide bolt forward and lower bolt handle. Rifle is now cocked and loaded.

**TO LOAD MAGAZINE** — (Model 581) Put safety **ON SAFE**. Remove clip magazine by pushing rearward on magazine latch (Fig. 4) and pulling clip from bottom of rifle. Load cartridges into magazine. When fully loaded, magazine will hold five (5) cartridges. To replace magazine, fit channel opening on back of magazine over end of magazine guide.

Push magazine upward until locked into place by magazine latch. (Model 582) Put safety **ON SAFE**. Unlock tubular magazine by turning knurled plug at front of tube. Pull tube from magazine until loading port is open. Load cartridges into port, bullet end forward. Magazine is loaded to capacity when bullet end of last cartridge shows in port. Close tube over cartridges, rotating to lock plug to magazine. If magazine is loaded beyond capacity, plug will not lock to magazine tube.

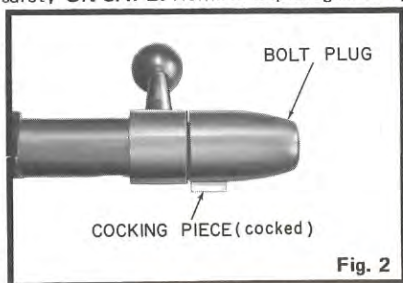
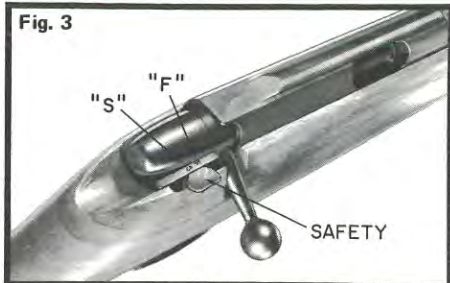

Fig. 2

**TO FIRE AND EJECT** — **Caution:** Before firing be sure barrel is clean-free of heavy oil, grease or any obstruction. Be sure rifle is pointed where you want to shoot. Rotate safety to forward stop position marked "F" on receiver. Trigger can be pulled and rifle fired. To eject fired case, lift bolt handle and pull bolt fully rearward.

**TO UNLOAD MAGAZINE** — The Model 581 clip magazine may be easily unloaded after removal from rifle. Slide cartridges forward and out of magazine. The Model 582 tubular magazine is unloaded very simply. Put safety **ON SAFE**, lift bolt handle and pull bolt rearward to open action. **Caution:** After replacing and locking tube into empty magazine, open and close action repeatedly to remove any cartridges remaining in action or chamber. End of colored magazine follower can be seen from open action position when action is empty.



**TO UNLOAD CHAMBER** — Make sure muzzle is pointed in a safe direction. Put safety **ON SAFE**. Raise bolt handle, open action and remove cartridge from chamber.

**TO REMOVE BOLT** — Lift bolt handle and pull bolt rearward to bolt stop. Rotate and hold safety completely forward and withdraw bolt from rifle.

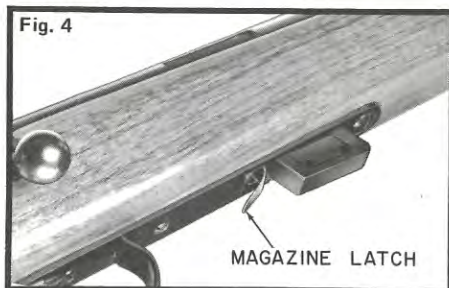

**CLEANING AND CARE** — Remove bolt. Wipe bore with 22 caliber cleaning patch. It is important that bore be cleaned from breech to muzzle to prevent shooting residue in barrel from falling into action. Use lightly oiled cloth patch after cleaning. Wire brush, if necessary, with powder solvent. Should it be necessary to clean action, the stock should be removed. Unscrew takedown screw. Remove stock. Wash action with petroleum solvent, such as kerosene. Wipe clean and re-oil lightly. Cocking cam surfaces on bolt should be kept lubricated. When shooting in freezing weather, remove excess oil and use dry graphite as lubricant. Handling leaves invisible "prints" of moisture that can cause rust to metal parts. Wipe receiver and barrel with oiled cloth after handling. Abrupt changes in temperature cause condensation and moisture; therefore special care to interior metal parts is needed to prevent rusting.

**SIGHT ADJUSTMENT** — Sights are carefully adjusted at factory. However, re-alignment may be required for individual shooters.

**WINDAGE** — The dovetail front sight may be moved right or left in sight slot. Use a plastic hammer and support barrel firmly to avoid damage. Move front sight to right to move target impact to left. Move sight to left to move target impact to right.

**ELEVATION** — Turn elevation screw (Fig. 5) to loosen rear sight eyepiece (Fig. 5) on sight leaf. Raise or lower eyepiece and tighten in desired position. Raise eyepiece for longer range or to raise bullet impact on target. Lowering eyepiece will shorten range or drop bullet impact on target.

**RECEIVER GROOVES** — Two dovetail grooves are cut along top of receiver. A receiver type mount may be attached. Remove eyepiece if necessary. Mount may be easily slipped into grooves and tightened in desired position.

**MAINTENANCE** — Gun should be checked periodically by a competent gunsmith to ensure proper inspection and any necessary replacement of worn or damaged parts.

**IMPORTANT:** This gun has been manufactured to Remington specifications and shipped from the factory suitable for use. Remington does not recommend and is not responsible for any alteration or modification to the gun not made by Remington factory personnel, nor the replacement of worn or damaged parts with those not of Remington manufacture.

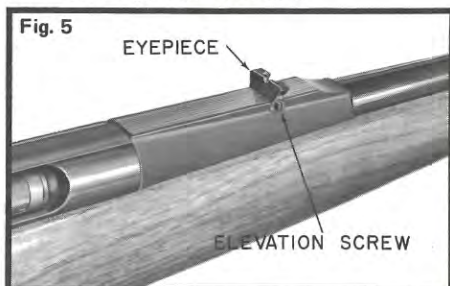

**SHOOTING GLASSES.** Smart shooters, who don't normally wear corrective lenses, always hunt and shoot wearing good, impact-resistant shooting glasses in order to protect their eyes against unanticipated ricochet, possible powder blowback, or branch and twig whiplash. In addition to eye safety, green or gray glasses keep the eyes fresh and untired on bright, glary days, while yellow lenses aid in spotting game in dim or fading light. So for safety, comfort and better shooting — both in the field and on the target range — shooting glasses are a real "must".

# MODELS 581-582 22 CALIBER BOLT ACTION RIFLES

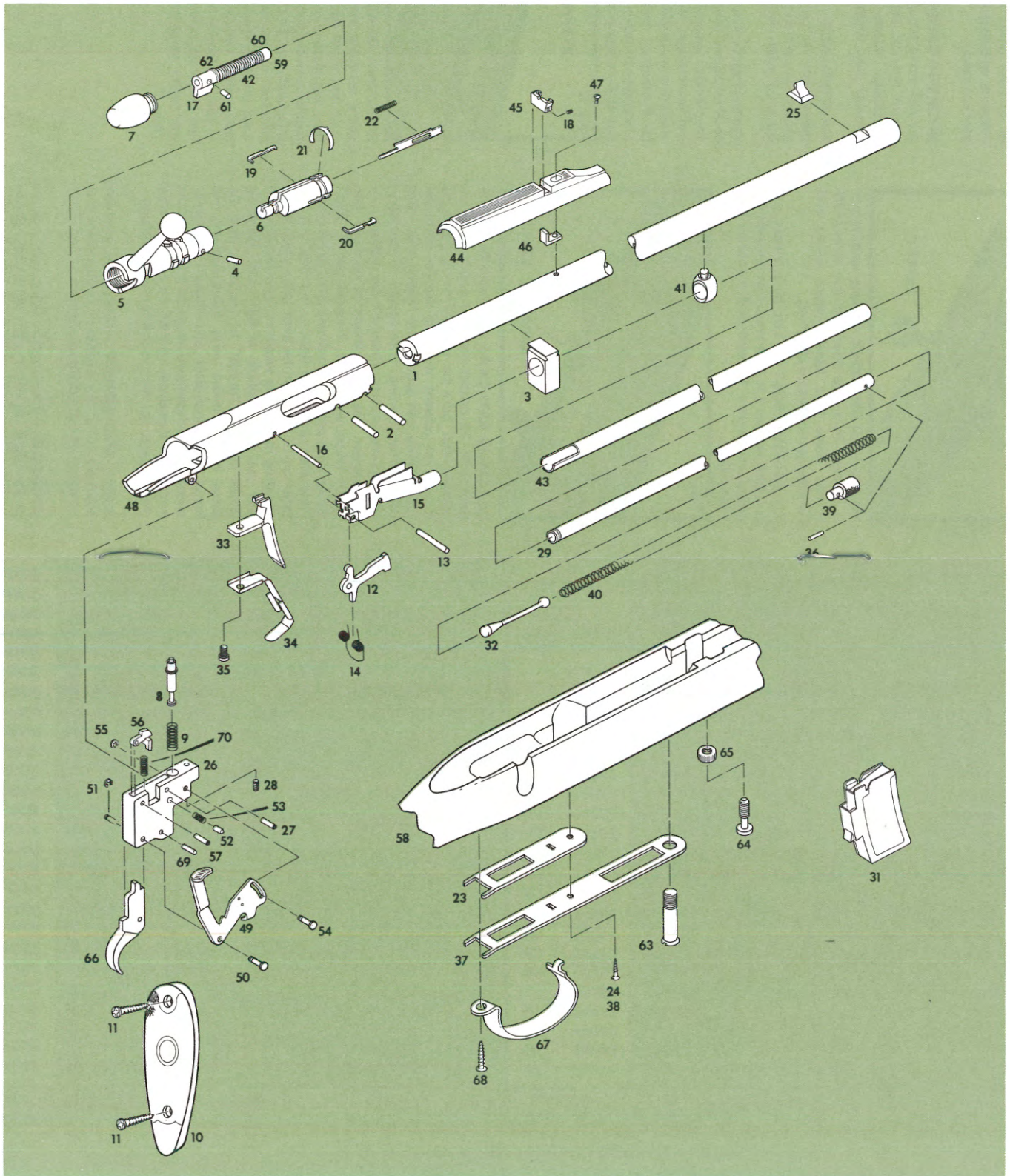

Send all guns for factory service and inquiries on service and parts to  
**REMINGTON ARMS COMPANY, INC.**  
Arms Service Division  
Ilion, New York 13357

All other inquiries are to be addressed to  
**REMINGTON ARMS COMPANY, INC.**  
Bridgeport, Connecticut 06602

**MODELS**

**581**

**582**

**22 CALIBER  
BOLT ACTION RIFLES**

**PARTS LIST**

NOTE: SEE INSTRUCTIONS FOR ORDERING PARTS.

View No.	Part No.	NAME OF PART	View No.	Part No.	NAME OF PART
	14657	Barrel (581) - - - - - (Restricted)	54	91370	Safety Retainer Pin - - - - -
1	29030	Barrel (582) - - - - - (Restricted)	55	14044	Safety Retainer Pin Retaining Washer - - - - -
2	91342	Barrel Assembly Pin - - - - -	56	14503	Sear - - - - - (Restricted)
3	14036	Barrel Bracket (582) - - - - -	57	24477	Sear Pin - - - - -
	29105	Bolt Assembly Complete - - - - - (Restricted)		29056	Stock Assembly (581) - - - - -
4	18382	Bolt Assembly Pin - - - - -	58	29057	Stock Assembly (582) - - - - -
5	29000	Bolt Body Assembly - - - - - (Restricted)	59	29112	Striker Assembly - - - - -
6	33660	Bolt Head - - - - - (Restricted)	60	14014	Striker - - - - -
7	14005	Bolt Plug - - - - -	61	14565	Striker Cross Pin - - - - -
8	14002	Bolt Stop - - - - -	62	14012	Striker Washer - - - - -
9	14024	Bolt Stop Spring - - - - -	63	14071	Takedown Screw (581) - - - - -
10	17578	Butt Plate - - - - -	64	14043	Takedown Screw (582) - - - - -
11	25410	Butt Plate Screw - - - - -	65	14265	Takedown Screw Escutcheon (582) - - - - -
	29005	Cartridge Feed Insert Assembly (582) - - - - -	66	14033	Trigger - - - - - (Restricted)
12	14016	Carrier (582) - - - - -	67	14971	Trigger Guard - - - - -
13	14017	Carrier Pin (582) - - - - -	68	14042	Trigger Guard Screw - - - - -
14	14018	Carrier Spring (582) - - - - -		29015	Trigger Housing Assembly - - - - -
15	14019	Cartridge Feed Insert (582) - - - - -	69	14031	Trigger Pin - - - - -
16	14020	Cartridge Feed Insert Pin (582) - - - - -	70	14045	Trigger Spring - - - - -
17	91509	Cocking Piece - - - - - (Restricted)			
18	14236	Elevation Screw - - - - -			
19	14008	Extractor, L.H. - - - - -			
20	14009	Extractor, R.H. - - - - -			
21	14010	Extractor Spring - - - - -			
22	91472	Firing Pin Return Spring - - - - -			
23	14069	Floor Plate (582) - - - - -			
24	14099	Floor Plate Screw (582) - - - - -			
25	14001	Front Sight - - - - -			
26	14026	Housing - - - - - (Restricted)			
27	14031	Housing Pin - - - - -			
28	14027	Housing Lock Screw - - - - -			
	29115	Inner Magazine Tube Assembly (582) - - - - -			
29	14267	Inner Magazine Tube (582) - - - - -			
31	29075	Magazine Assembly (581) - - - - -			
	14495	Magazine Shoe - - - - -			
32	14022	Magazine Follower (582) - - - - -			
33	14047	Magazine Guide (581) - - - - -			
34	14048	Magazine Latch (581) - - - - -			
35	14049	Magazine Latch Screw (581) - - - - -			
36	25090	Magazine Pin (582) - - - - -			
37	29050	Magazine Plate (581) - - - - -			
38	14099	Magazine Plate Screw (581) - - - - -			
39	25095	Magazine Plug (582) - - - - -			
40	14268	Magazine Spring (582) - - - - -			
41	16739	Magazine Ring (582) - - - - -			
42	14884	Main Spring - - - - - (Restricted)			
43	29095	Outer Magazine Tube (582) - - - - -			
	29100	Rear Sight Assembly - - - - -			
44	14038	Rear Sight Base - - - - -			
45	14059	Rear Sight Eyepiece - - - - -			
46	14051	Rear Sight Leaf - - - - -			
47	14034	Rear Sight Screw - - - - -			
	29126	Receiver Assembly (581) - - - - - (Restricted)			
48	29127	Receiver Assembly (582) - - - - - (Restricted)			
49	28240	Safety - - - - -			
50	14015	Safety Pivot Pin - - - - -			
51	14044	Safety Pivot Pin Retaining Washer - - - - -			
52	14497	Safety Detent - - - - -			
53	14498	Safety Detent Spring - - - - -			

**MODEL 581 LEFT HAND**  
NOTE: See Right Hand Action for Parts Not Listed

29160	Bolt Assembly, Complete - - - - - (Restricted)
30700	Bolt Body Assembly - - - - - (Restricted)
14065	Bolt Plug - - - - -
30655	Receiver Assembly - - - - - (Restricted)
29176	Stock Assembly - - - - -

**MODEL 581 BR**

29062	Stock Assembly - - - - -
-------	--------------------------

**ACCESSORIES**

25571	Sling Strap Assembly & Mountings, complete (581) - - - - -
29090	Sling Strap Assembly & Mountings, complete (582) - - - - -

# INSTRUCTIONS FOR ORDERING PARTS

## (PLEASE READ CAREFULLY)

Please give model number, part number and name. Give serial number and state caliber or gauge and choke. Identify parts from list, picture or exploded view. List interchangeable shotgun barrels on separate order form to speed shipment.

Cover only one subject in letter or order. Do not order parts and give repair instructions in same letter.

Please do not ship sample parts if they may be identified otherwise. See shipping instructions below.

Parts will be supplied for discontinued models if available. Parts cannot be supplied nor guns repaired if not listed in complete line parts list. **IMPORTANT:** Do not combine Part Orders with Gun Service Orders. Please send Part Orders direct to:

**REMINGTON ARMS COMPANY, INC.**  
PARTS DEPT.  
ARMS SERVICE DIVISION  
Ilion, New York 13357

# INSTRUCTIONS FOR FACTORY SERVICE

## (PLEASE READ CAREFULLY)

Please package carefully. Use plenty of cushioning material to prevent movement of gun or parts in package. Please do not ship gun in a gun case, or special container that must be returned. Return of gun or parts will be speeded if properly packaged in a throw-away carton. Clearly mark forwarding and return address on gun package as well as on attached letter.

Securely attach complete letter of information on outside of each package returned to factory for repairs. Please do not return gun accessories such as sling straps, quick release swivels, special boots, covers, telescopes, mounts or any special equipment to factory with gun shipment. Give full details of contents. State if complete gun or part. List model number, part number and name, serial number and caliber or gauge. Give full condition of contents — any parts missing or damaged, etc. This will enable us to accurately list needed repairs.

Do not order parts and give repair instructions in same letter. To avoid delay in starting work, please include in first order or letter the trouble to be corrected, changes desired or parts to be replaced. If an estimate is required please advise. Otherwise work will proceed and a statement of cost will be sent. This will speed service.

Unless specified otherwise, shipments will be made by way of Parcel Post on small packages, Express on larger packages. Remington gun parts are not interchangeable with those of any other make. For this reason the Remington Arms Company, Inc., cannot service any gun not of its manufacture.

Repairs will be made on discontinued models as long as supply of parts is available. However, repairs cannot be made for models which are not listed in Complete Line Parts Lists.

**IMPORTANT: IT IS A FEDERAL OFFENSE TO SHIP FIREARMS AND AMMUNITION TOGETHER. BEFORE PACKAGING FIREARMS FOR RETURN TO FACTORY, ALL LIVE AMMUNITION SHOULD BE REMOVED.**

If live ammunition is included in package, shipment cannot be made by Insured Mail. All other shipments may be made by Insured Mail, Please send repairs direct to:

**REMINGTON ARMS COMPANY, INC.**  
ARMS SERVICE DIVISION  
Ilion, New York 13357

For instructions how to dress, ship and deliciously cook wild game, send for the Remington "Wild Game" Cookbook \$3.95 — Remington Sportsmen's Library, P.O. Box 432, Bridgeport, Conn. 06601.